

## 58B AKA 59B Mechanical Seals for Chemical Pumps, Water Pumps, Compressors 58B (59B)型机械密封

**Structural Features:** single end, multiple springs, balanced, independent direction of rotation, bolt and lug combined transmission. The way of transmission is simple and reliable. The compensation components are pre-assembled and is easy to install. The load to the seal faces are balanced. The whole seal component is easy to adjust and the sealing performance is great and stable. Two 58B or 59B seals can be assembled with itself or each other working together as a double end seal.

**结构特点:** 单端面、多弹簧、平衡型、任意旋向、螺钉凸耳组合传动。传动方式简单可靠，补偿元件整体预装，便于安装，补偿性能好；端面负荷均匀，安装简单，调整方便，密封性能稳定可靠，适用范围广、互换性强。

**Standards:** ISO3069, GB6556, DIN24960, EN12756  
**符合标准:** ISO3069, GB6556, DIN24960, EN12756

**Scopes of Application:** widely used in chemical pumps, water pumps, piping pumps, screw pumps and compressors for chemical processing, oil refining, petrochemical engineering, chemical fiber, food processing, pharmacy, paper pulp and environmental protection industries.

**应用领域:** 广泛应用于石油、化工、化纤、食品、医药、纸浆、环保等领域。  
可同化工泵、清水泵、管道泵、螺杆泵、压缩机等旋转设备配套。

**Inner Diameter:** 14 mm to 100 mm  
**规格范围:** 14 mm -100 mm

### Materials

Rotary Ring Face: Carbon/SiC/TC  
Stationary Ring Face: Al<sub>2</sub>O<sub>3</sub>/SiC/TC  
Elastomers: NBR/EPDM/Viton/PTFE/FFKM  
Springs: SS304/SS316/HC-276  
Metal Parts: 410S/SS304/SS316/SS316L/Hastelloy

### 材料

旋转环端面: 石墨/碳化硅/碳化钨  
静止环端面: 氧化铝/碳化硅/碳化钨  
辅助密封: 丁腈橡胶/三元乙丙橡胶/氟橡胶/聚四氟乙烯/全氟醚橡胶  
弹簧: SS304/SS316/HC-276  
金属部件: 410S/SS304/SS316/SS316L/哈氏合金

### Operation Parameters

Pressure: ≤ 4.0 MPa  
Temperature: - 40 ~ 200 °C  
Linear Speed: ≤ 25 m/s

### 运行参数

压力: ≤ 4.0 MPa  
温度: - 40 ~ 200 °C  
线速度: ≤ 25 m/s

**Mediums:** oil, water, amorphism acid, alkali, salt, and organic solvents.

**适用介质:** 水、油、非结晶性酸、碱、盐、有机溶剂等。

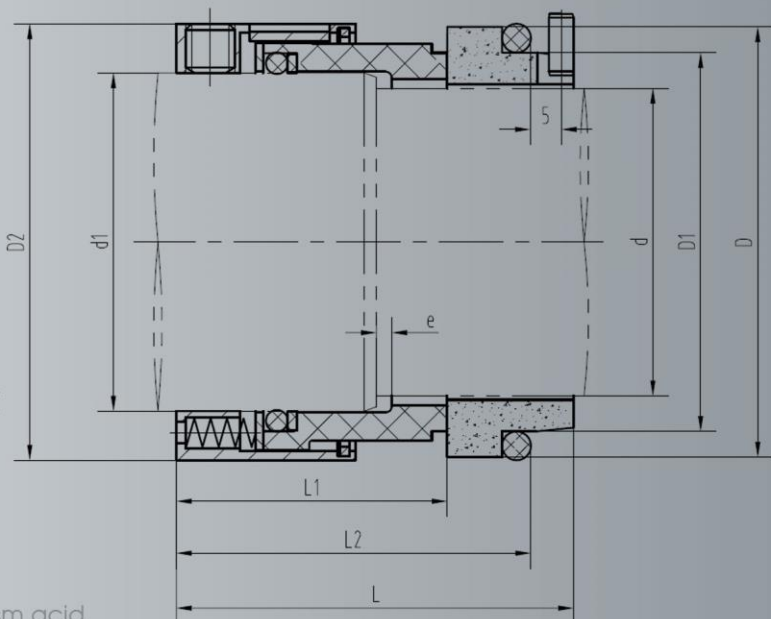

## 58B (59B) Mechanical Seal Dimension Chart - 58B (59B)型机械密封尺寸对照表

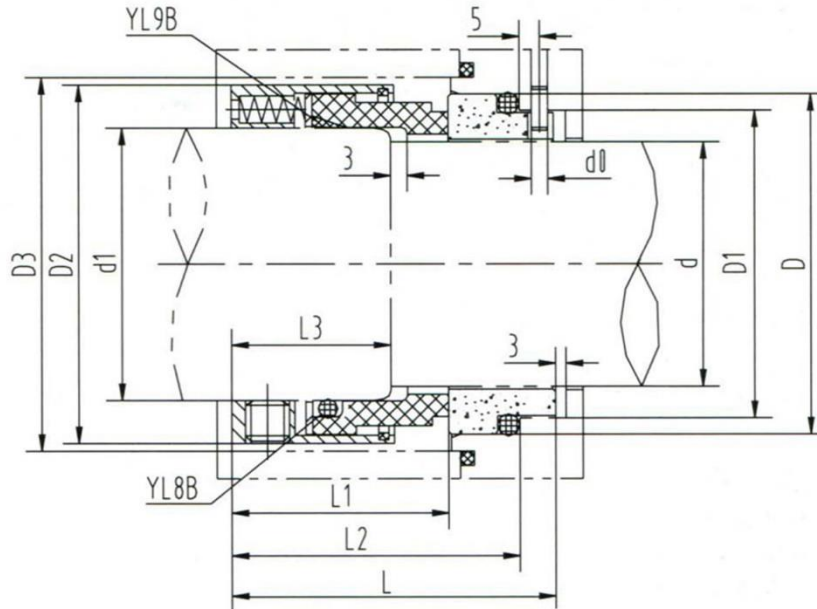

Dimensions	d	d1	D	D1	D2	D3	L	L1	L2	L3	d0
Shaft Sizes	h6	h6	H8	H11							
20	20	24	35	29	38	40	52.5	31.5	45.0	25.0	3
22	22	26	37	31	40	42	52.5	31.5	45.0	25.0	3
24	24	28	39	33	42	44	54.5	34.2	47.5	27.5	3
25	25	30	40	34	44	46	54.5	34.5	47.5	27.5	3
28	28	33	43	37	47	49	57.0	37.5	50.0	30.0	3
30	30	35	45	39	49	51	57.0	38.0	50.0	30.0	3
32	32	38	48	42	54	58	57.0	38.0	50.0	30.0	3
33	33	38	48	42	54	58	57.0	38.0	50.0	30.0	3
35	35	40	50	44	56	60	57.0	38.0	50.0	30.0	3
38	38	43	56	49	59	63	59.5	39.5	52.5	29.5	4
40	40	45	58	51	61	65	59.5	39.5	52.5	29.5	4
43	43	48	61	54	64	68	59.5	39.5	52.5	29.5	4
45	45	50	63	56	66	70	59.5	39.5	52.5	29.5	4
48	48	53	66	59	69	73	59.5	39.5	52.5	29.5	4
50	50	55	70	62	71	75	64.5	44.0	57.5	32.5	4
53	53	58	73	65	78	83	64.5	44.0	57.5	32.5	4
55	55	60	75	67	80	85	64.5	44.0	57.5	32.5	4
58	58	63	78	70	83	88	69.5	49.0	62.5	37.5	4
60	60	65	80	72	85	90	69.5	49.0	62.5	37.5	4
63	63	68	83	75	88	93	69.5	49.0	62.5	37.5	4
65	65	70	85	77	90	95	69.5	49.0	62.5	37.5	4
70	70	75	92	83	99	104	77.0	55.5	70.0	42.0	4
75	75	80	97	88	104	109	77.0	55.5	70.0	42.0	4
80	80	85	105	95	109	114	77.0	55.0	70.0	42.0	4
85	85	90	110	100	114	119	82.0	60.0	75.0	47.0	4
90	90	95	115	105	119	124	82.0	60.0	75.0	47.0	4
95	95	100	120	110	124	129	82.0	60.0	75.0	47.0	4
100	100	105	125	115	129	134	82.0	60.0	75.0	47.0	4